

Referenz-Nr. Order No.	S	d (F7)	H2	D1	H (±0.01)	D	M	Dp	R
1474-06000	2	12	10	28	50	65	M8	40	160
1474-08000	2.5	16	12	34	63	80	M10	50	180

Referenz-Nr. Order No.	D2	H1	zulässige Belastung (N) Allowable Operating Load (N)	Spannkraft Clamping Force Kgf	empfohlene Toleranz für Werkstückstärke Recommended Workpiece Thickness Tolerance	 (kg)
1474-06000	26	36	600	600	±0.5	1.2
1474-08000	28	45	600	800	±0.8	2.2

1474

- Schwarz beschichtet

1474

- Black coated

Hinweis

- Spannbolzen und Zugschrauben müssen extra bestellt werden.

Note

- Clamping Pins or Screws must be ordered separately.

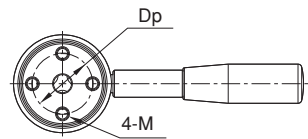
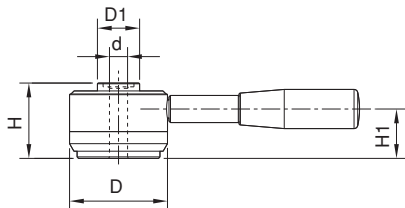

3 mögliche Montagepositionen für den Griff

The handle can be removed by loosening the locking screw. To keep the handle mounted permanently, make sure that the locking screw is fully tightened. 3 options of handle mounting position.

